

# EMISSION CONTROL SYSTEM

## Saudi Arabian Specifications with CB-23 Engine and Automatic Transmission

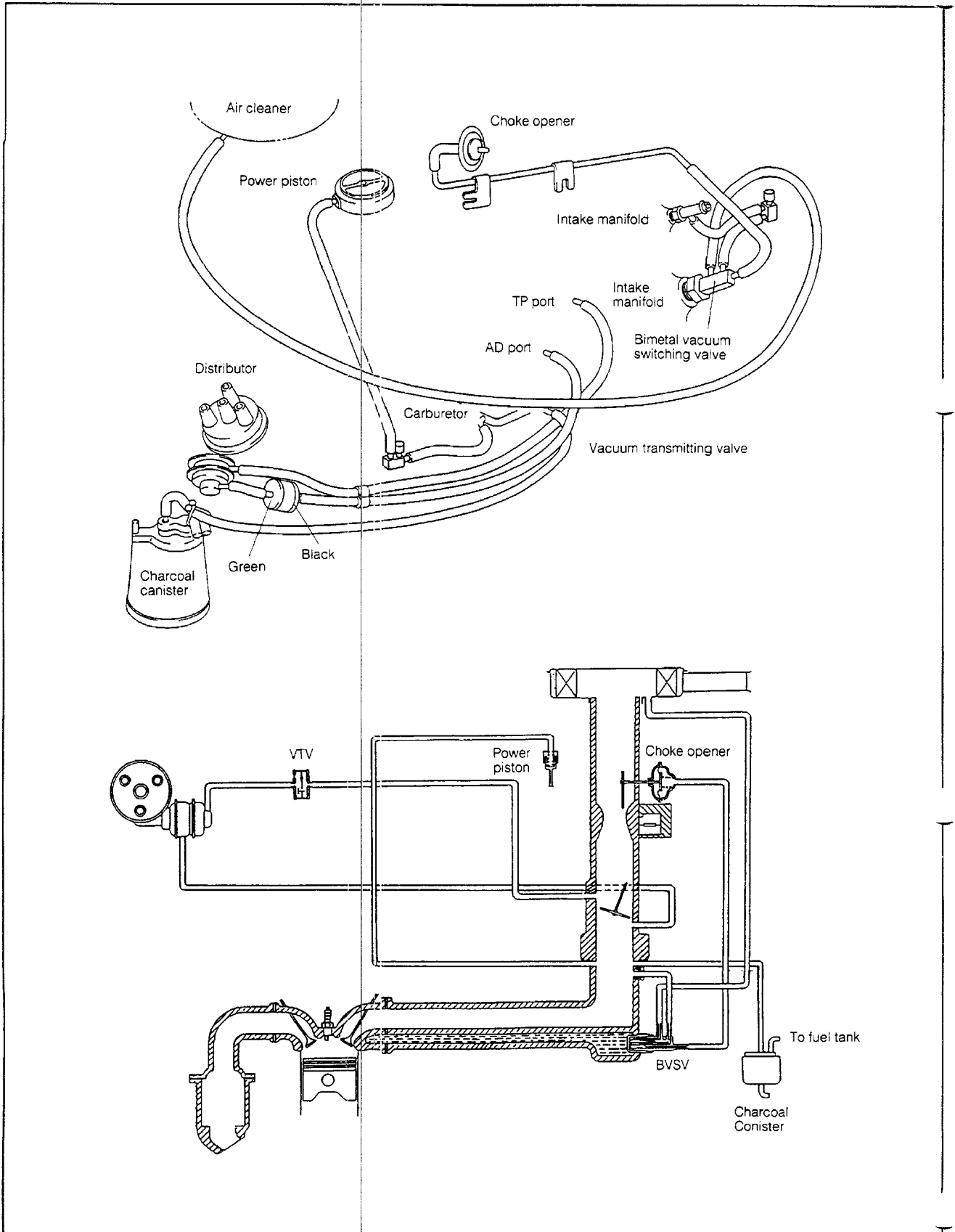

Fig. 12-8

WM-12010

# EMISSION CONTROL SYSTEM

Singapore Specifications with CB-23 Engine and Manual Transmission

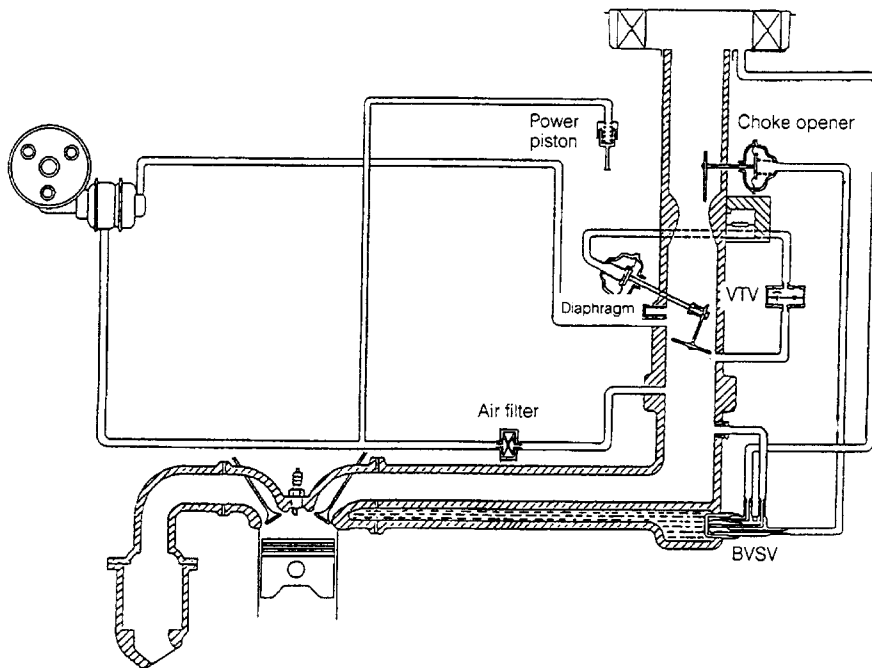
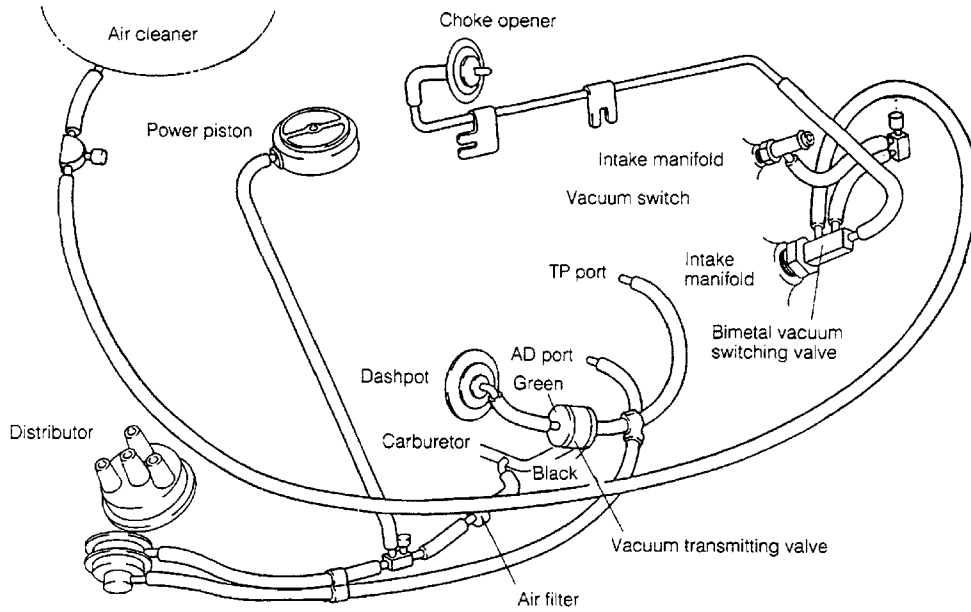

Fig. 12-9

WM-12011

# EMISSION CONTROL SYSTEM

## Singapore Specifications with CB-23 Engine and Automatic Transmission

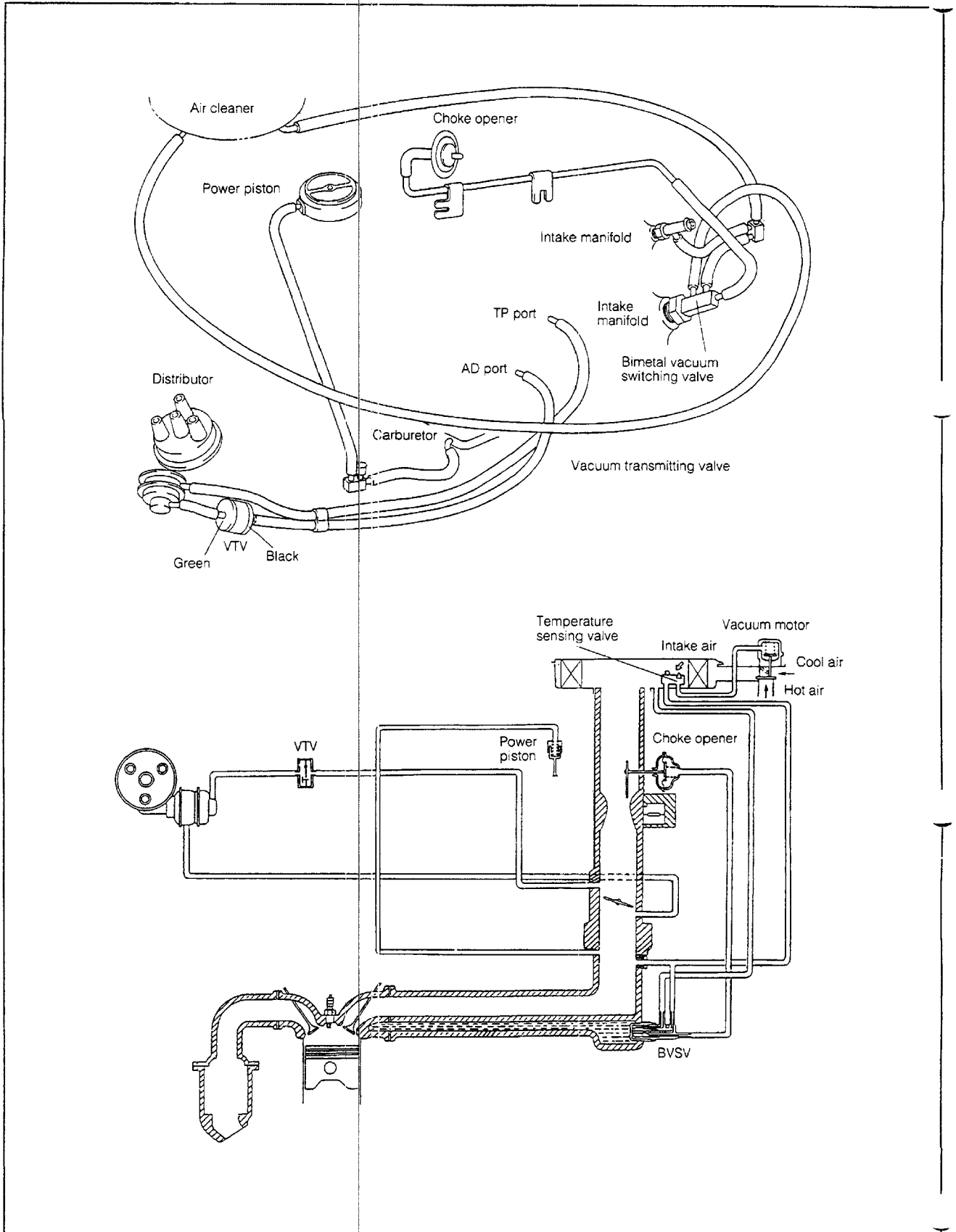

Fig. 12-10

WM-12012

# EMISSION CONTROL SYSTEM

## Swedish Specifications with CB-23 Engine and Manual Transmission

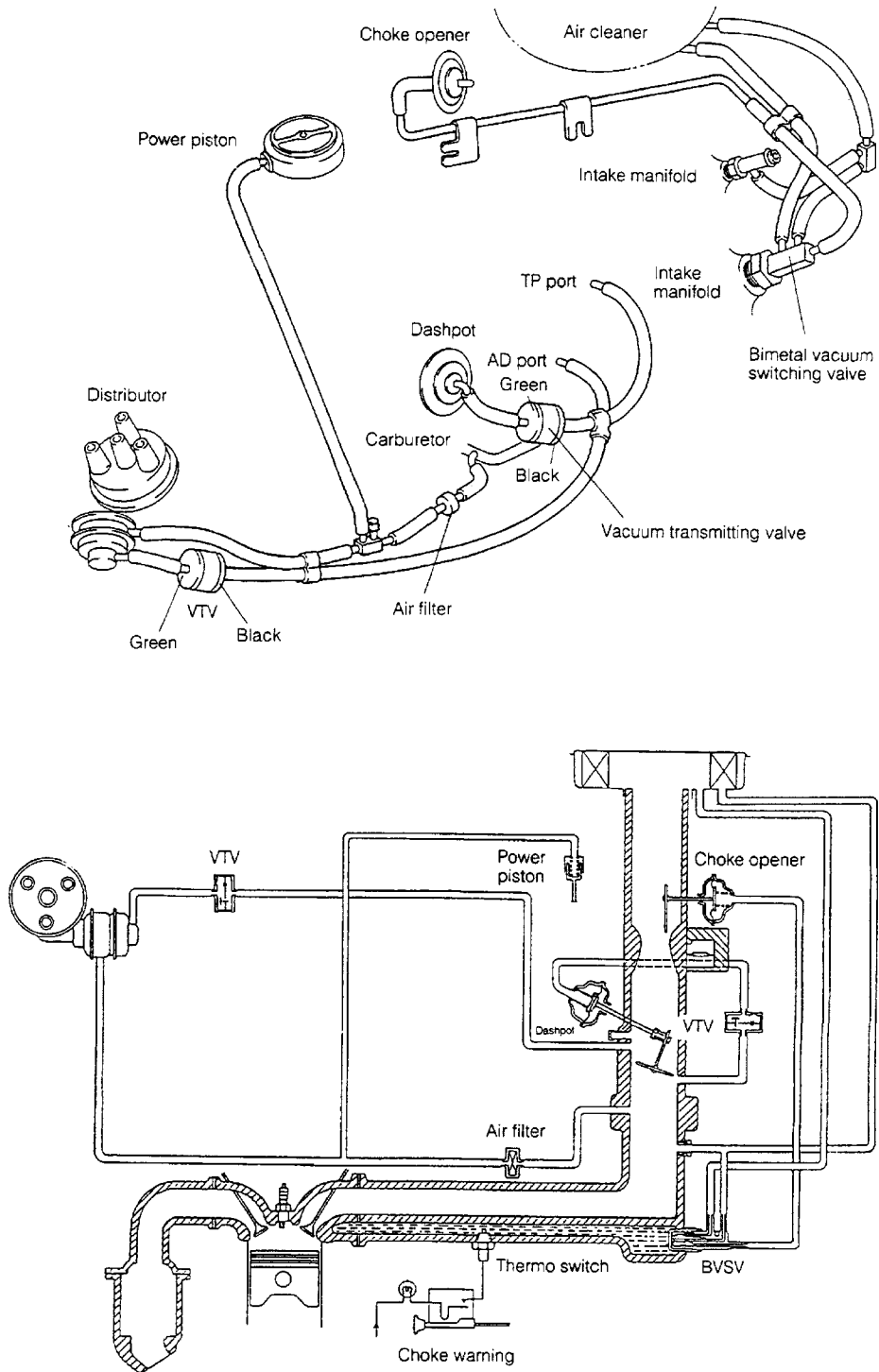

Fig. 12-11

WM-12013

# EMISSION CONTROL SYSTEM

## Swiss Specifications with CB-23 Engine and Manual Transmission

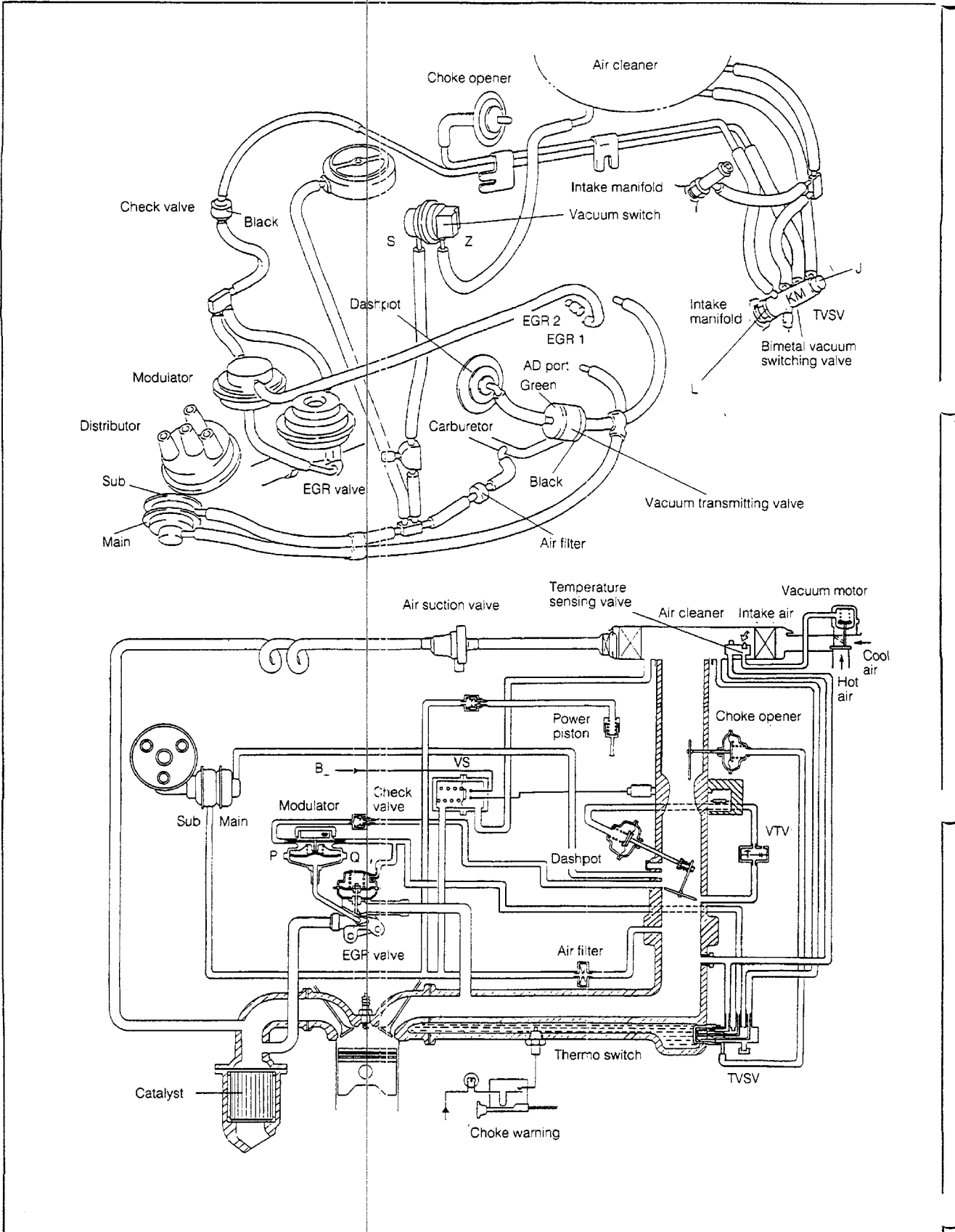

Fig. 12-12

WM-12014

# EMISSION CONTROL SYSTEM

## General Specifications with CB-61 Engine

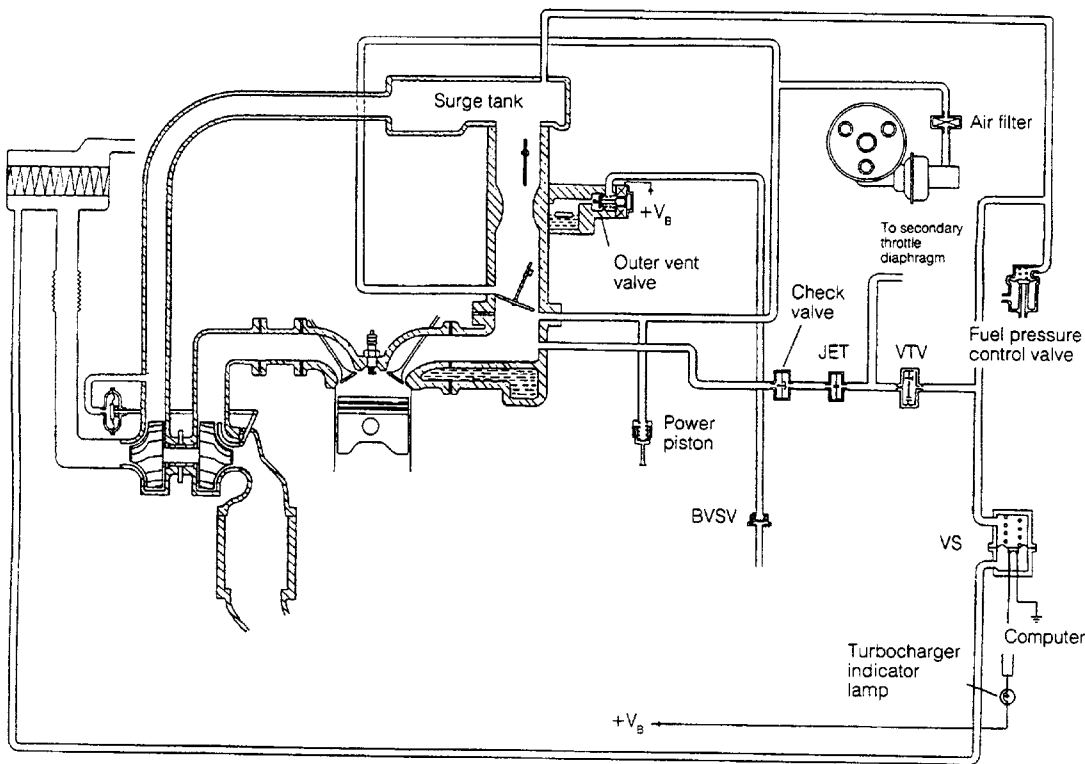
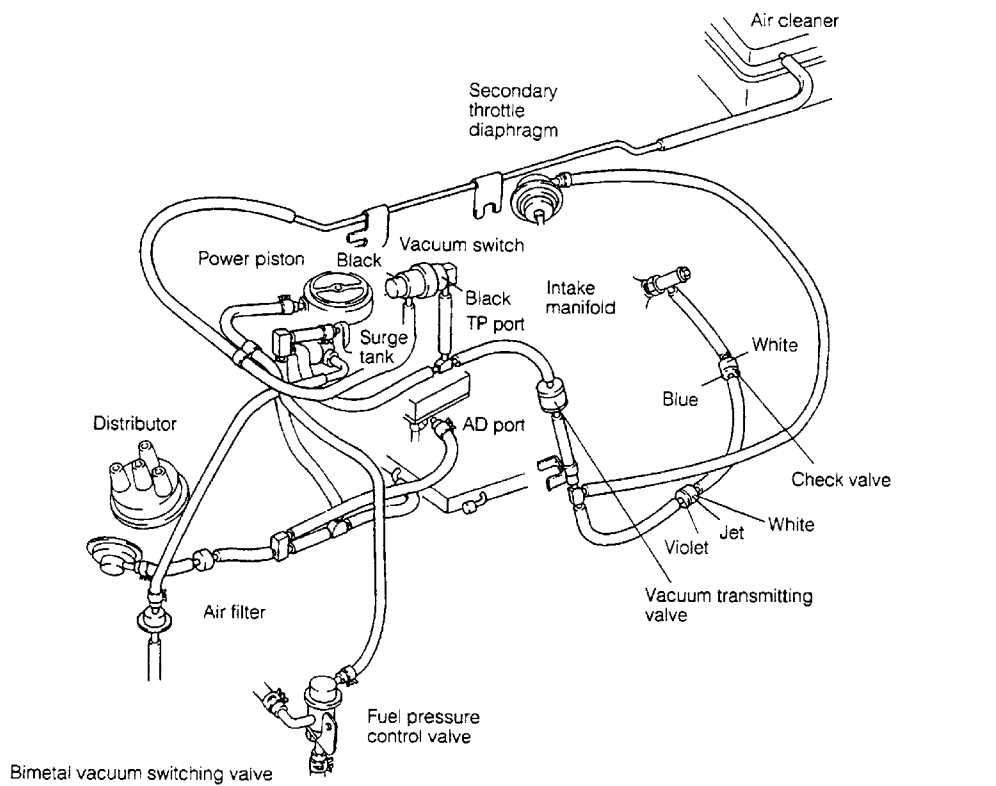

Fig. 12-13

WM-12015

# EMISSION CONTROL SYSTEM

## Australian Specifications with CB-61 Engine

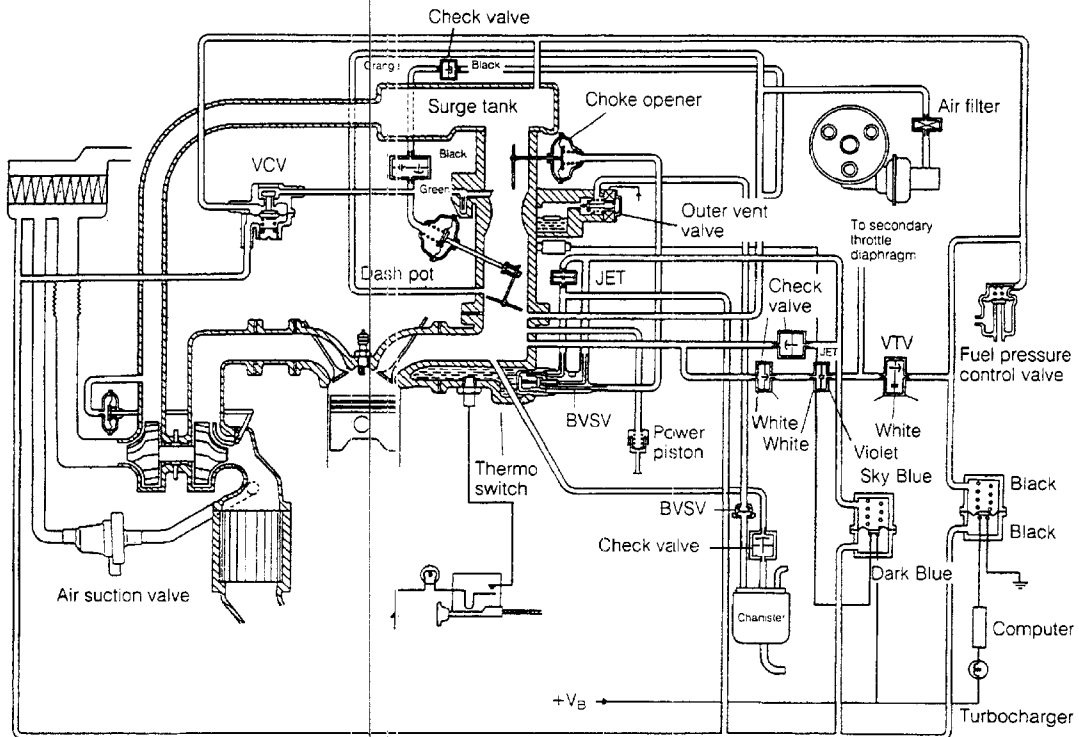
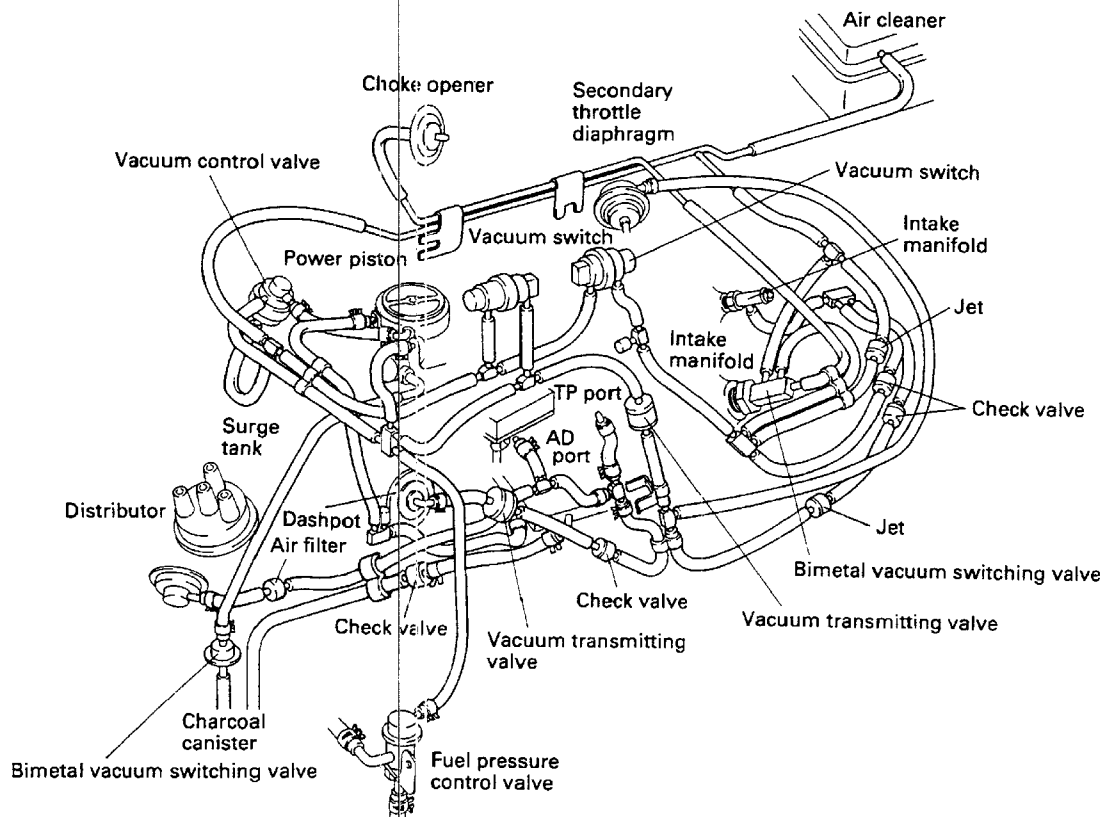

Fig. 12-14

WM-12016